



Artisit rendering view from NW 22nd Street and NW 1st Avenue;
Painting and landscaping to be completed prior to 2011.

Mailing Address:
2136 NW 1st Avenue
Miami, FL 33127
(305) 600-4785

Office access is located on NW 21st Street

**Soho Studios At The Wynwood Convention Center
is distinguished as the only City of Miami Convention Center offering
well-equipped, “raw” facility spaces to meet any events’ needs.**



Managed by Rothschild and Associates LLC



Actual photography taken at Soho Studios events.

Soho Studios

is literally a "Blank Canvas" ready to be painted with the brilliant colors of every composer, designer, and event planner.

- ▣ Offering full Catering, Production, and Decor services
- ▣ The ONLY city of Miami event venue with Convention Center Status
- ▣ Nearly 70,000 square feet of flexible, raw space
- ▣ 15 minutes to Miami International Airport
- ▣ 7 minutes to Miami Beach, Brickell Avenue, and Coconut Grove
- ▣ Adjacent to downtown Miami
- ▣ Blocks from the Adrienne Arsht Center, Midtown and the Miami Design District
- ▣ 20 minutes to Ft. Lauderdale International Airport
- ▣ Offering discount hotel room blocks through three hotels on Biscayne Bay with easy access to Soho Studios
- ▣ Managed by Rothschild and Associates LLC
RothschildandAssociates.com

ARMORY HALL Plan

Featuring a 20-ft high ceiling.

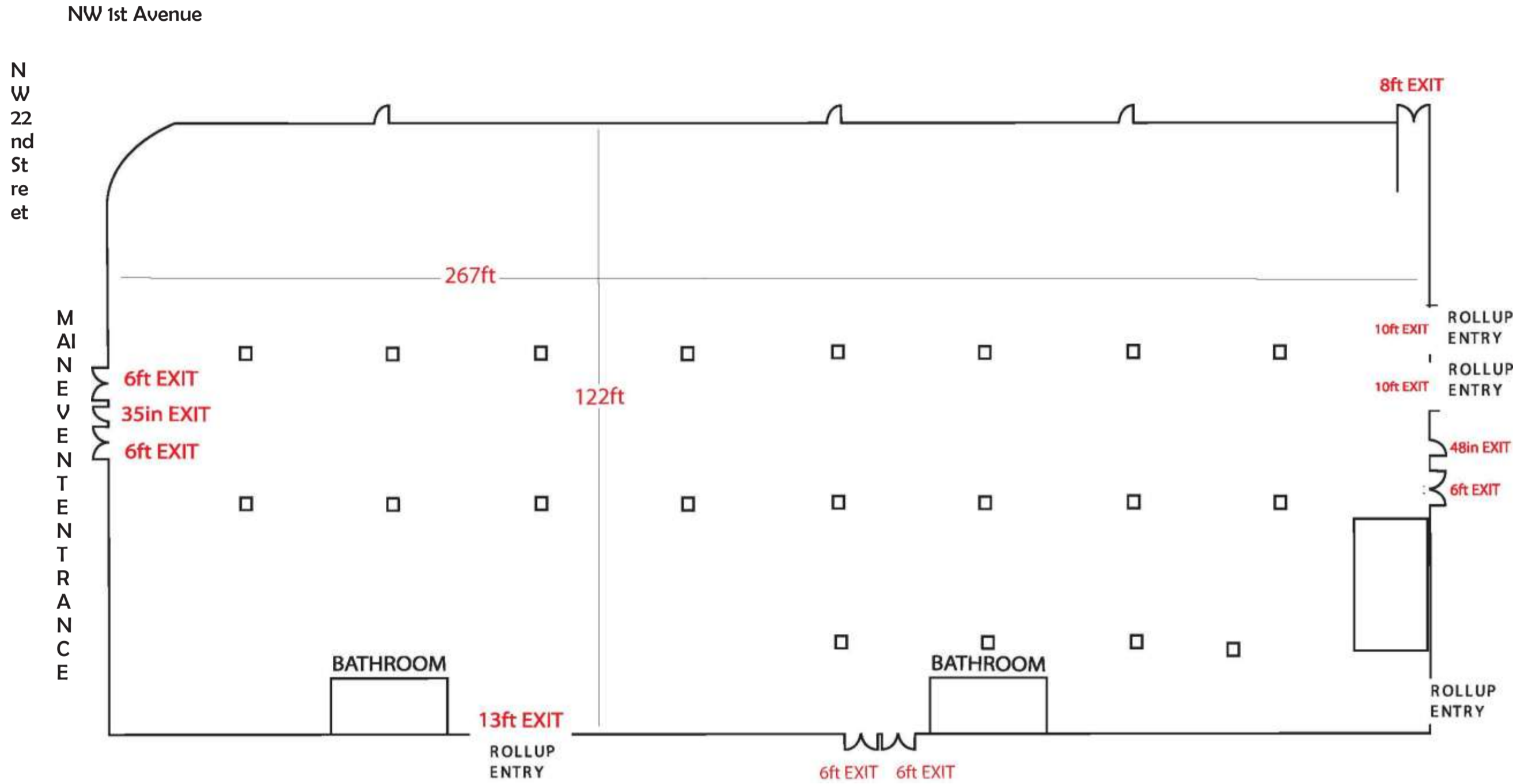

Area:
33,118 sq. ft. / 2,997 sq. m.

Dimensions:
267'x122' ft. / 81x37 m.

Capacity:
2,207

Electric:

PAVILION HALL Plan

Featuring a wood-beam vaulted ceiling.

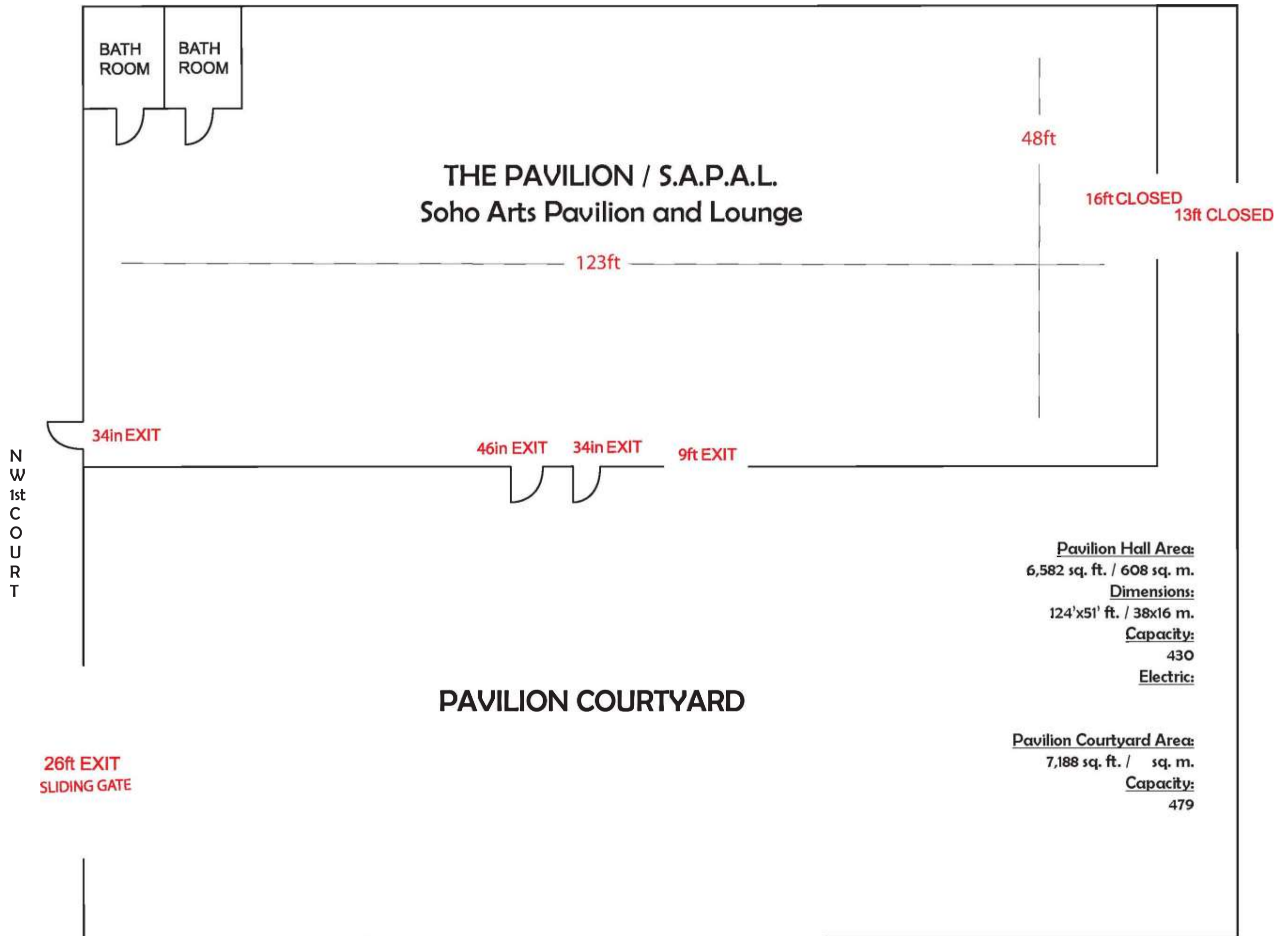

PARLIAMENT HALL Plan

Second floor featuring more than 20 windows, loft-style ceiling, and elevator access.

First floor featuring 5 roll-up doors with direct access to the main courtyard.

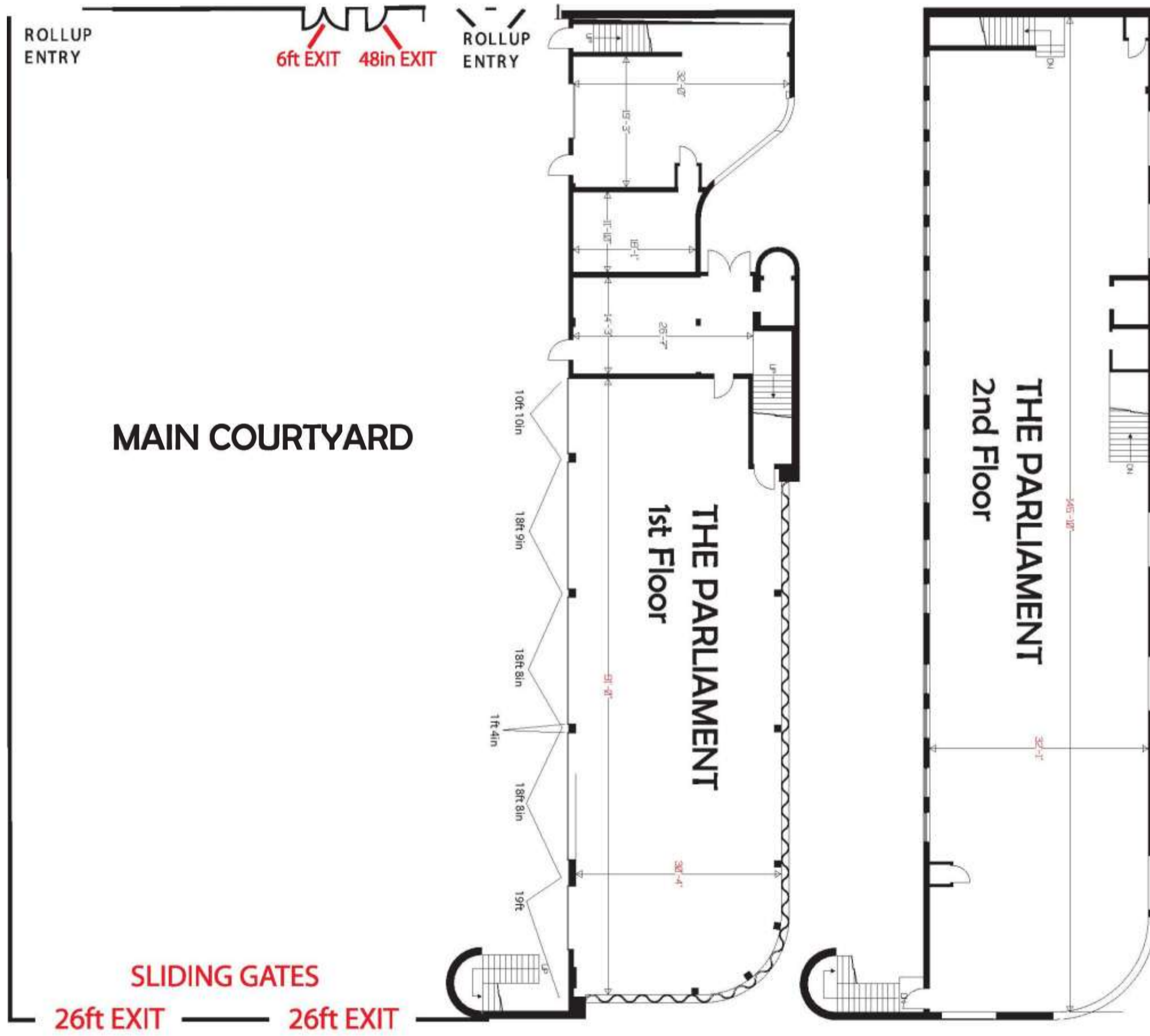

N
W
1st
A
ve
nu
e

Parliament Hall Area 2nd Flr:
 5,003 sq. ft. / 440 sq. m.
Dimensions:
 145'x32' ft. / 44x10 m.
Capacity:
 306
Electric:

Parliament Hall Area 1st Flr:
 2,730 sq. ft. / 252 sq. m.
Dimensions:
 91'x30' ft. / 28x9 m.
Capacity:

Electric:

Main Courtyard Area:
 13,050 sq. ft. / 1,188 sq. m.
Dimensions:
 90'x145' ft. / 22x44 m.
Capacity:
 882

NW 21st Street

LOCATION

All roads lead to Soho Studios At The Wynwood Convention Center

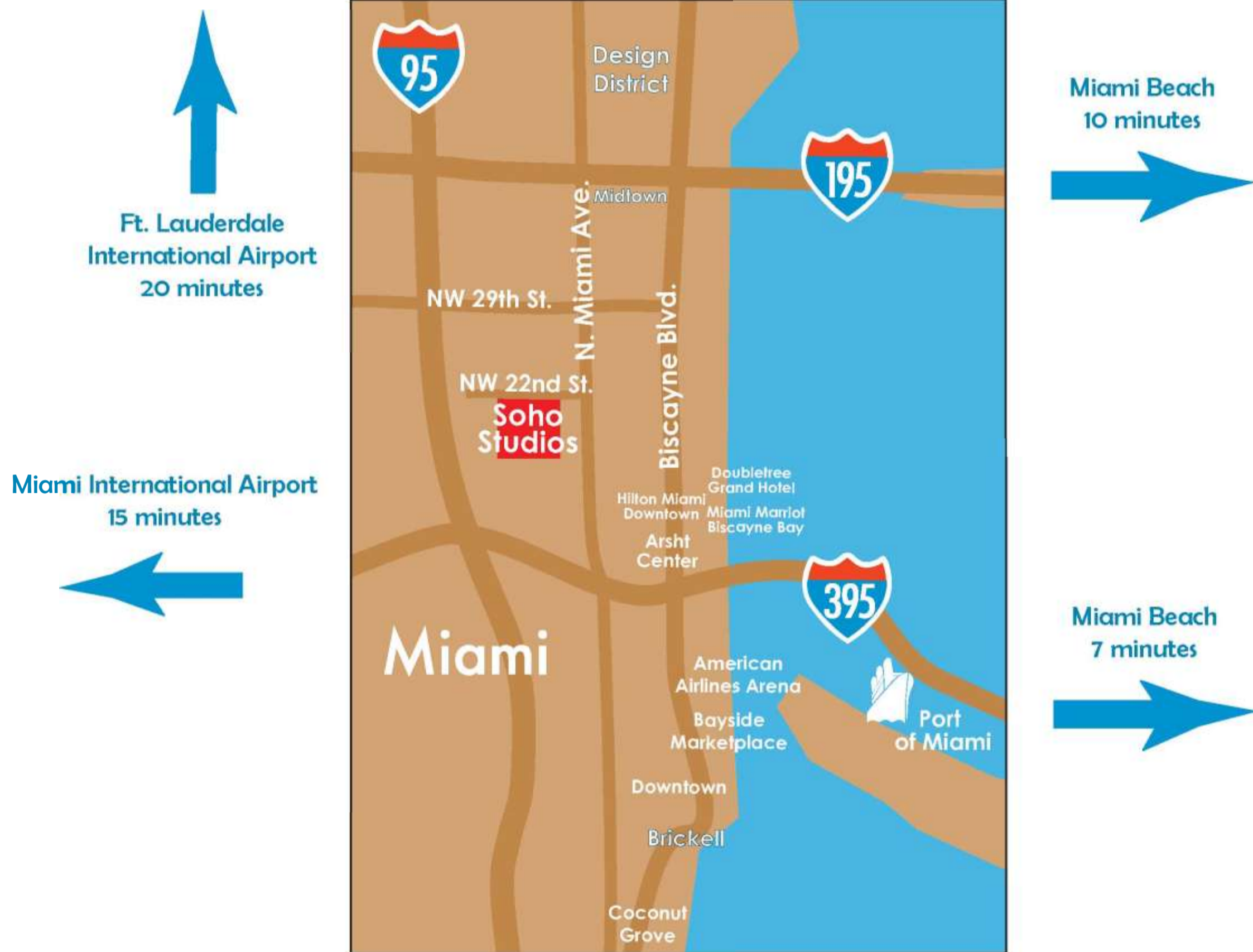



SOHO ARTS PAVILION & LOUNGE (S.A.P.A.L.)

Purpose

The Soho Arts Pavilion & Lounge's mission is to provide a sophisticated, yet casual, gathering space to encourage networking and support of the often under-served artistic talent in our midst. SAPAL will partner with South Florida's diverse cultural organizations and artists to feature exhibitions, performances and symposiums in ways that will educate, inspire and give back to all who participate. Future goals include expansion beyond regional borders to achieve greater visibility for the Wynwood Arts District.

About the space

Soho Arts Pavilion & Lounge is located in Miami's burgeoning Wynwood Arts District. The 6,000 square foot pavilion is designed to be flexible, with movable walls for art exhibitions, video projections, symposiums, or open space for a dance or music performance.

Equipped with a bar and comfortable seating arrangements, the multi-faceted Lounge aims to become a destination for those who live and work in Wynwood, as well as residents of surrounding communities such as downtown Miami, the Brickell area and all along the Biscayne Corridor.

SAPAL will also be available to events scheduled at Soho Studios At The Wynwood Convention Center, which houses the Pavilion. The Wynwood Convention Center offers more than 70,000 square feet of event space, equipped with full production and catering services.

What events will SAPAL promote?

We believe that an open forum—with targeted marketing for each event—will attract new audiences to Wynwood, of varying ages and demographics. To fulfill its mission, SAPAL will:

- invite non-profit groups and arts organizations to host events
- invite independent curators to submit exhibition proposals
- provide space to artists working in any medium who otherwise do not have access to traditional exhibition/performance venues
- produce seminars on a variety of noteworthy topics
- stage music and dance performances
- offer space for charity functions
- promote events in the space on behalf of our clients that rent the space
- remain open to new ideas...

Who we are

The people behind SAPAL bring vast experience to the project. Andrew Rothschild, president of the Rothschild and Associates LLC, which manages the entire Wynwood Convention Center—leads the team that includes: Glenn Orgin, COO of the Wynwood Convention Center; and Kristina Amador, Director of Special Events & Sales for Soho Studios; plus an on-site support staff focused on the details. We are proud members of Greater Miami Convention & Visitors Bureau, Greater Miami & The Beaches Hotel Association, WADA (Wynwood Art District Association, GatheringGuide.com, MPI (Meeting Planner International) and Film Florida

Why are we doing this?

Everyone talks these days about educating a broader audience to support the arts, so in a way our goal is not so different from the galleries that surround us in Wynwood, or from the new centers for performing arts, or the local museums. We've all seen how the arts impact our local economy, our international reputation, tourism and—most importantly—our state of mind. SAPAL is unique, however, in that we have no set rules to govern the space. Flexibility is a rare commodity these days, so we're here to shake things up a bit, have fun and impart some knowledge if we can. You could say it's our take on being socially responsible.

NOTES